

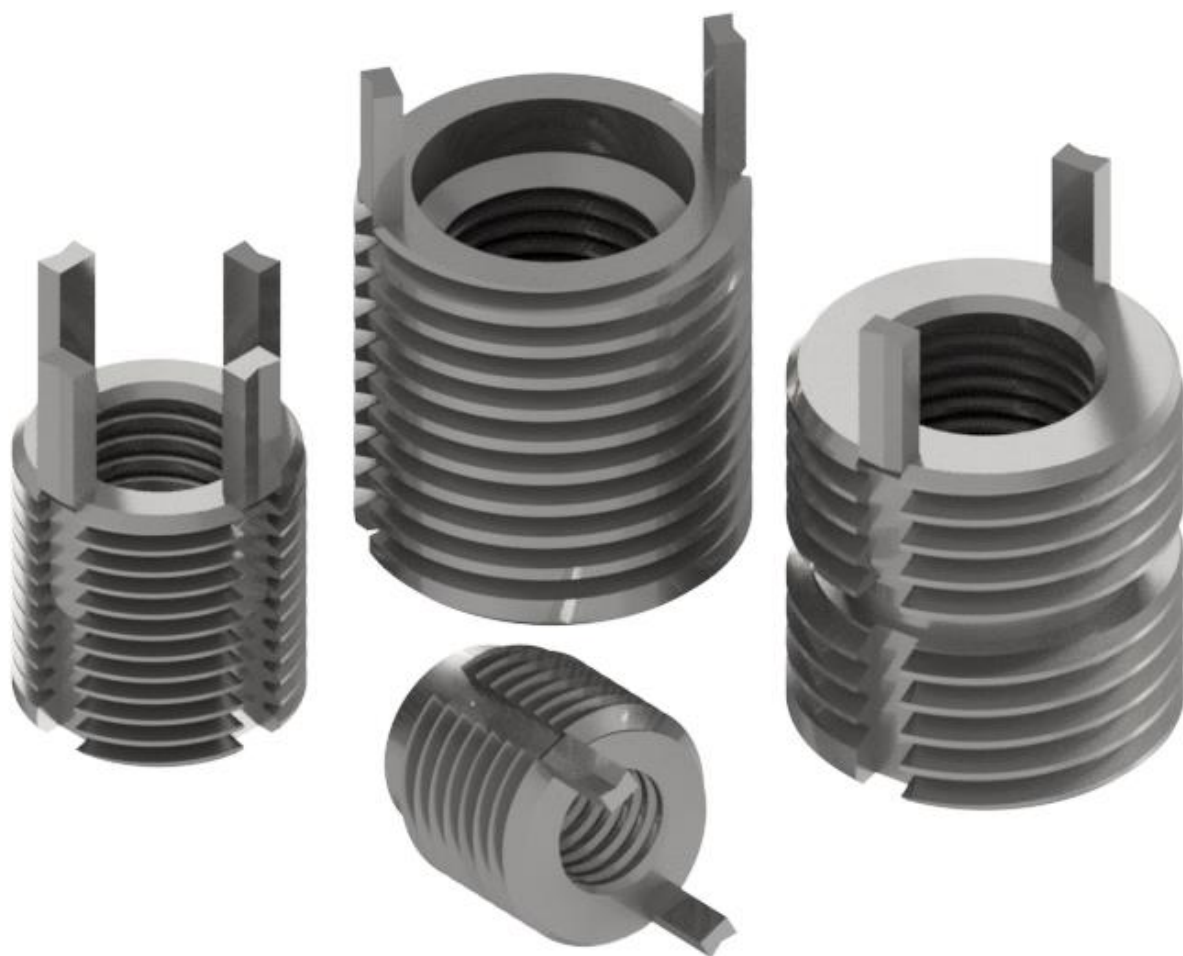

SPECIAL THREADED INSERTS





Quality Sistem Certified Company UNI EN ISO 9001:2015 Reg.3023-A





INDEX

-  ATSKNCM Series Threaded InsertsPag. 04

-  ATSKNM Series Threaded InsertsPag. 05

-  ATSKNHM Series Threaded InsertsPag. 06

-  ATSKNC Series Threaded InsertsPag. 08

-  ATSKN Series Threaded InsertsPag. 08

-  ATSKNH Series Threaded InsertsPag. 10

THREADED INSERTS WITH LOCKING KEYS

ATSKNCM Series Threaded Inserts

TYPE "S"

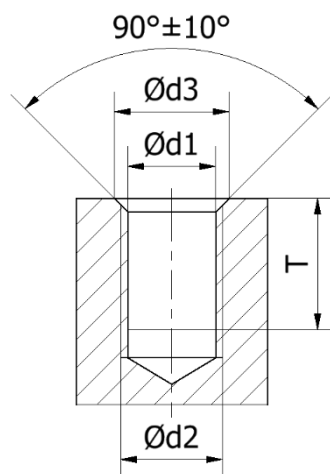
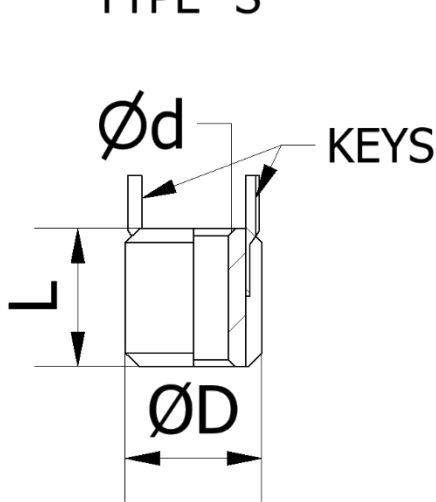

TYPE "L"
(ATSKNCML)

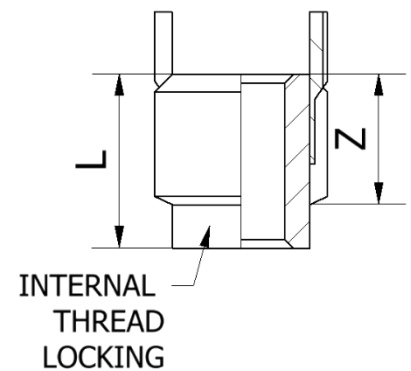

Code		Dimensions					Installation					Removal	
Standard	Locking	Internal Ød 5H/4H5H	External ØD	Anchor mm2	L ±0,25	Z	d1 Pre-drilling Tapping	d3 Countersunk	Thread		Code Laying Tool	Tip	
									Ø d2 6H	T Min.		Ø	Depth
ATSKNCM2X0,4		M2X0,4	M4X0,7	16,5	3	3,4	+0,080	4,1	M4X0,7	4,0	ATSTKNCM2X0,40	2,8	2,00
	ATSKNCML2X0,4			10,3			-0,025						
ATSKNCM2,5X0,45		M2,5X0,45	M4,5X0,75	26,5	3,8	3,9	+0,080	4,6	M4,5X0,75	5,0	ATSTKNCM2,5X0,45	3,0	2,00
	ATSKNCML2,5X0,45			15,9			-0,025						
ATSKNCM3X0,5		M3X0,5	M5X0,8	33,1	4,25	4,4	+0,080	5,1	M5X0,8	5,5	ATSTKNCM3X0,50	3,5	2,25
	ATSKNCML3X0,5			21,4			-0,025						
ATSKNCM4X0,7		M4X0,7	M6X0,75	58,4	5,25	5,5	+0,080	6,1	M6X0,75	6,5	ATSTKNCM4X0,70	4,6	2,50
	ATSKNCML4X0,7			42,9			-0,025						



ATSKNM Series Threaded Inserts

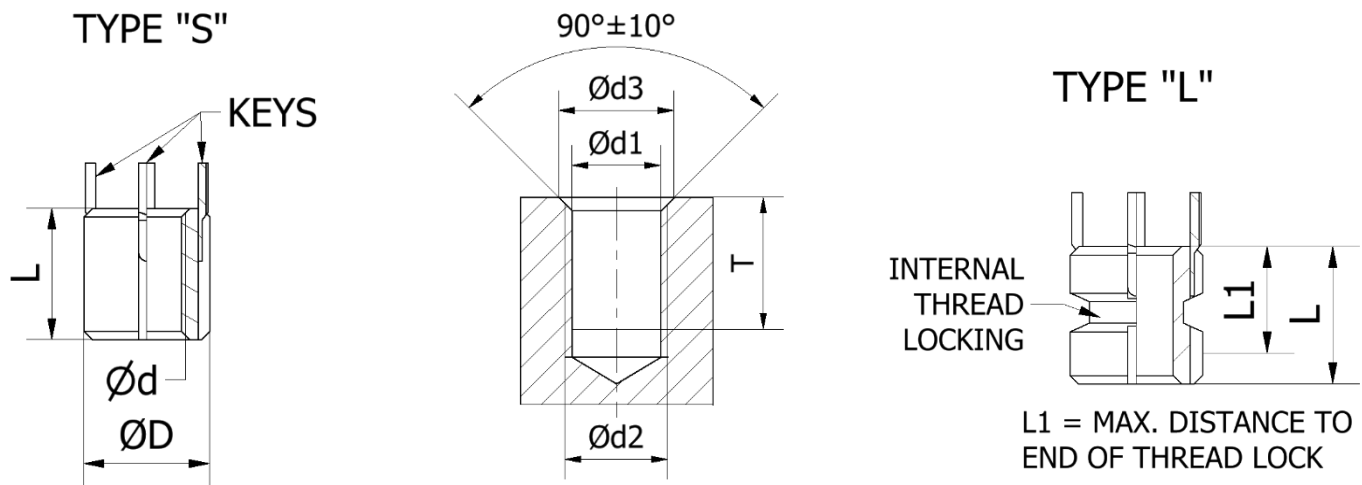

Code		Dimensions					Installation					Removal	
Standard	Locking	Internal Ød 5H/4H5H	External ØD	Anchor mm2	L ±0,30	L1	d1 Pre-drilling Tapping	d3 Countersunk	Thread		Code Laying Tool	Tip	
									Ø d2 6H	T Min.		Ø	Depth
ATSKNM5X0,8		M5X0,8	M8X1,25	104,9	8		+0,100	8,25	M8x1,25	9,5	ATSTM-5	5,5	4,00
	ATSKNML5X0,8			83,1			7,6						
ATSKNM5X0,5		M5X0,5	M8X1,25	104,9	8		+0,100	8,25	M8x1,25	9,5	ATSTM-5	5,5	4,00
	ATSKNML5X0,5			83,1			7,0						
ATSKNM6X1		M6X1,0	M10X1,25	177,7	10		+0,100	10,25	M10x1,25	11,5	ATSTM-6	7,5	4,75
	ATSKNML6X1			152,7			8,2						
ATSKNM6X0,75		M6X0,75	M10X1,25	177,7	10		+0,100	10,25	M10x1,25	11,5	ATSTM-6	7,5	4,75
	ATSKNML6X0,75			152,7			7,3						
ATSKNM8X1,25		M8X1,25	M12X1,25	266,7	12		+0,100	12,25	M12x1,25	13,5	ATSTM-8	9,5	4,75
	ATSKNML8X1,25			242,7			9,5						
ATSKNM8X1		M8X1	M12X1,25	266,7	12		+0,100	12,25	M12x1,25	13,5	ATSTM-8	9,5	4,75
	ATSKNML8X1			242,7			9,0						
ATSKNM10X1,5		M10X1,5	M14X1,5	341,6	14		+0,130	14,25	M14x1,5	15,5	ATSTM-10	11,5	4,75
	ATSKNML10X1,5			316,4			10,0						
ATSKNM10X1,25		M10X1,25	M14X1,5	341,6	14		+0,130	14,25	M14x1,5	15,5	ATSTM-10	11,5	4,75
	ATSKNML10X1,25			316,4			9,5						
ATSKNM12X1,75		M12X1,75	M16X1,5	470,2	16		+0,130	16,25	M16x1,5	17,5	ATSTM-12	13,5	4,75
	ATSKNML12X1,75			441,4			11,2						
ATSKNM12X1,25		M12X1,25	M16X1,5	470,2	16		+0,130	16,25	M16x1,5	17,5	ATSTM-12	13,5	4,75
	ATSKNML12X1,25			441,4			10,2						

ATSKNHM Series Threaded Inserts

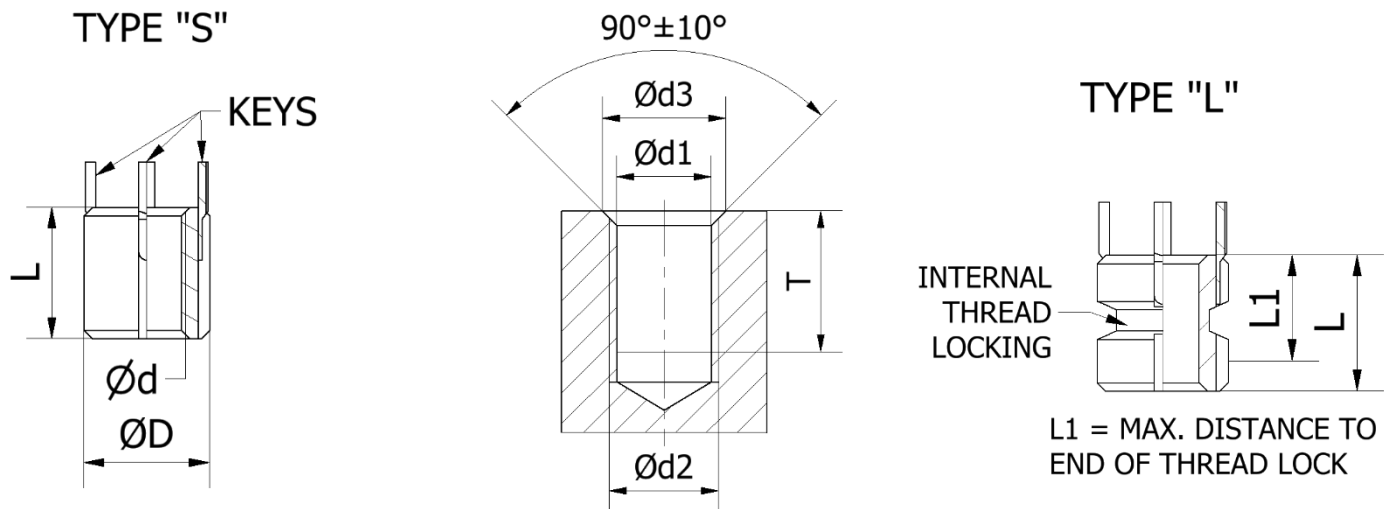

Code		Dimensions					Installation					Removal		
Standard	Locking	Internal Ød 5H/4H5H	External ØD	Anchor mm ²	L ±0,30	L1	d1 Pre-drilling Tapping		d3 Countersunk	Thread		Code Laying Tool	Tip	
							Ø	T		Ø d2 6H	T Min.		Ø	Depth
ATSKNHM4X0,7		M4X0,7	M8X1,25	104,9	8	6,9	+0,100	8,25	M8X1,25	9,5	ATSTHM-4	5,5	4,00	
	ATSKNHML4X0,7			83,1			-0,025							
ATSKNHM5X0,8		M5X0,8	M10X1,25	177,1	10	8,8	+0,100	10,25	M10X1,25	11,5	ATSTHM-5	7,5	4,75	
	ATSKNHML5X0,8			152,7			-0,025							
ATSKNHM6X1,0		M6X1,0	M12X1,25	266,7	12	10,8	+0,100	12,25	M12X1,25	13,5	ATSTHM-6	9,5	4,75	
	ATSKNHML6X1,0			242,5			-0,025							
ATSKNHM8X1,25		M8X1,25	M14X1,5	341,6	14	12,8	+0,130	14,25	M14X1,5	15,5	ATSTHM-8	11,5	4,75	
	ATSKNHML8X1,25			316,4			-0,025							
ATSKNHM8X1,0		M8X1,0	M14X1,5	341,6	14	12,8	+0,130	14,25	M14X1,5	15,5	ATSTHM-8	11,5	4,75	
	ATSKNHML8X1,0			316,4			-0,025							
ATSKNHM10X1,5		M10X1,5	M16X1,5	470,2	16	14,8	+0,130	16,25	M16X1,5	17,5	ATSTHM-10	13,5	4,75	
	ATSKNHML10X1,5			441,4			-0,025							
ATSKNHM10X1,25		M10X1,25	M16X1,5	470,2	16	14,8	+0,130	16,25	M16X1,5	17,5	ATSTHM-10	13,5	4,75	
	ATSKNHML10X1,25			441,4			-0,025							
ATSKNHM12X1,75		M12X1,75	M18X1,5	608,5	18	16,8	+0,130	18,25	M18X1,5	19,5	ATSTHM-12	15,5	4,75	
	ATSKNHML12X1,75			561,8			-0,025							
ATSKNHM12X1,25		M12X1,25	M18X1,5	608,5	18	16,8	+0,130	18,25	M18X1,5	19,5	ATSTHM-12	15,5	4,75	
	ATSKNHML12X1,25			561,8			-0,025							

ATSKNHM14X2,0		M14X2,0	M20X1,5	770,5	20	18,75	+0,130	20,25	M20X1,5	22,5	ATSTHM-14	17,50	4,75
	ATSKNHML14X2,0			724,4			-0,025						
ATSKNHM14X1,5		M14X1,5	M20X1,5	770,5	20	18,75	+0,130	20,25	M20X1,5	22,5	ATSTHM-14	17,50	4,75
	ATSKNHML14X1,5			724,4			-0,025						
ATSKNHM16X2,0		M16X2,0	M22X1,5	896,8	22	20,50	+0,130	22,25	M22X1,5	24,5	ATSTHM-16	17,75	4,75
	ATSKNHML16X2,0			855,2			-0,025						
ATSKNHM16X1,5		M16X1,5	M22X1,5	896,8	22	20,50	+0,130	22,25	M22X1,5	24,5	ATSTHM-16	17,75	4,75
	ATSKNHML16X1,5			855,2			-0,025						
ATSKNHM18X1,5		M18X1,5	M24X1,5	1084,4	24	22,50	+0,130	24,25	M24X1,5	26,5	ATSTHM-18	19,75	4,75
	ATSKNHML18X1,5			1051,5			-0,025						
ATSKNHM20X2,5		M20X2,5	M30X2,0	1774,3	30	28,00	+0,130	30,25	M30X2,0	34,5	ATSTHM-20	25,75	6,35
	ATSKNHML20X2,5			1736,4			-0,025						
ATSKNHM20X1,5		M20X1,5	M30X2,0	1774,3	30	28,00	+0,130	30,25	M30X2,0	34,5	ATSTHM-20	25,75	6,35
	ATSKNHML20X1,5			1736,4			-0,025						
ATSKNHM22X1,5		M22X1,5	M32X2,0	2045,9	32	30,00	+0,130	32,25	M32X2,0	36,5	ATSTHM-22	27,75	6,35
	ATSKNHML22X1,5			2014,7			-0,025						
ATSKNHM24X3,0		M24X3,0	M33X2,0	2189,4	33	31,00	+0,130	33,25	M33X2,0	37,5	ATSTHM-24	28,75	6,35
	ATSKNHML24X3,0			2161,9			-0,025						
ATSKNHM24X2,0		M24X2,0	M33X2,0	2189,4	33	31,00	+0,130	33,25	M33X2,0	37,5	ATSTHM-24	28,75	6,35
	ATSKNHML24X2,0			2161,9			-0,025						



ATSKNC Series Threaded Inserts

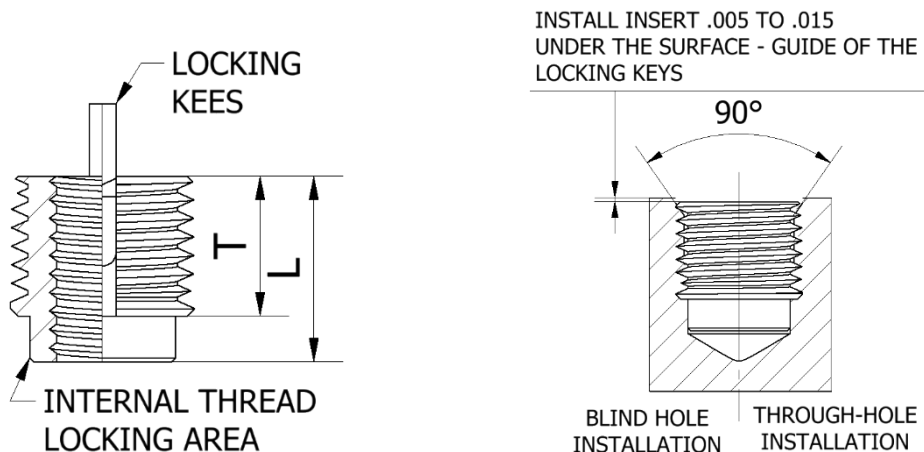

Code		Dimensions					Installation					Removal		
Standard	Locking	Ø Internal Thread	Ø External Thread	Anchor	L	T	Ø Pre-drilling Tapping	Ø Countersunk +.010/-,000	Thread		Code Laying Tool	Tip		
									UNF-2B Misure	Min. Depth.		Ø	Depth	
ATSKNC0080J		0-80 UNJF-3B	6-40 UNF-3A	.0132	.10	.085	.120	+0.003 -0.001	.140	6-40	.130	ATSTKNC008	#38 (.101)	1/16
ATSKNCC0256J	ATSKNCCL0256J	2-56 UNJC-3B	6-40 UNF-3A	.0132	.10	.085	.120	+0.003 -0.001	.140	6-40	.130	ATSTKNCCL02	#38 (.101)	1/16
ATSKNCA0256J	ATSKNCAL0256J	2-56 UNJC-3B	8-32 UNF-3A	.0157	.12	.090	.134	+0.003 -0.001	.166	8-32 UNC-2B	.140	ATSTKNC02	#33 (.113)	1/16
ATSKNCA0440J	ATSKNCAL0440J	4-40 UNJC-3B	10-32 UNF-2A	.0302	.17	.125	.161	+0.003 -0.001	.194	10-32	.160	ATSTKNC04	#29 (.136)	3/32
ATSKNC0632J	ATSKNCL0632J	6-32 UNJC-3B	12-28 UNF-2A	.0329	.17	.125	.187	+0.003 -0.001	.220	12-28	.160	ATSTKNC06	#21 (.159)	3/32
ATSKNCA0832J	ATSKNCAL0832J	8-32 UNJC-3B	**1/4-28 UNF-2A	.0669	.22	.175	.228	+0.003 -0.001	.255	1/4-28	.210	ATSTKNC08	#8 (.199)	1/8

ATSKN Series Threaded Inserts

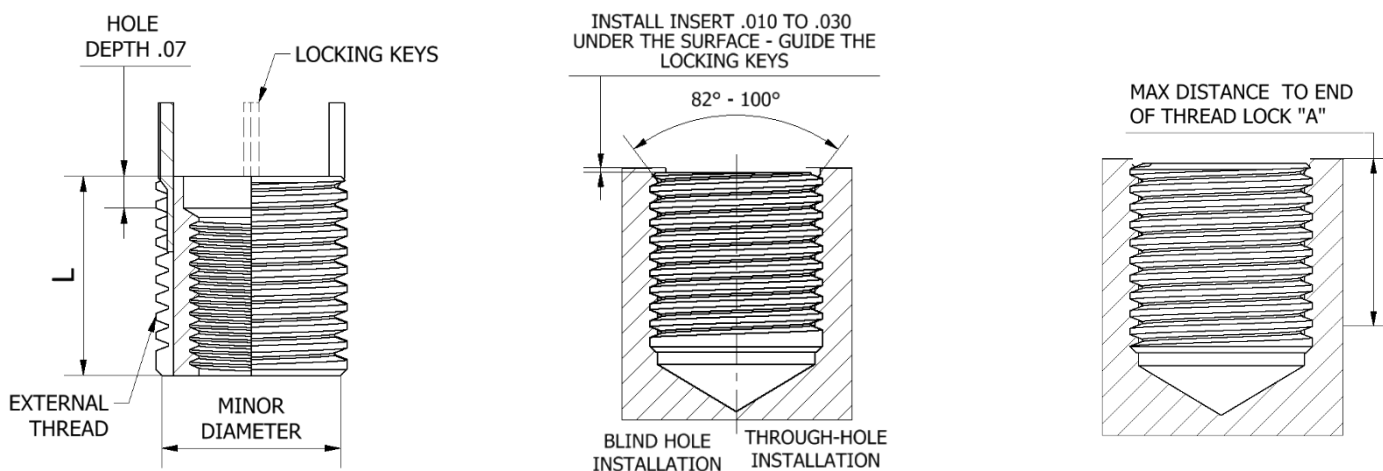

Code		Dimensions					Installation					Removal	
Standard	Locking	Ø Internal Thread 3B	Ø External Thread 2A	Anchor	L	T	Ø Pre-drilling Tapping	Ø Countersunk +,010/-,000	Thread		Code Laying Tool	Tip	
									UNF-2B Misure	Min. Depth.		Ø	Depth
ATSKN1024J		10-24	5/16-18	.1517			.272	.323	5/16-18	.37	ATSTD1024L	7/32	5/32
	ATSKNL1024J			.0945									
ATSKN1032J		10-32		.1517							ATSTD1032OL		
	ATSKNL1032J			.0945									
ATSKN420J		1/4-20	3/8-16	.2371			.332	.385	3/8-16	.43	ATSTD420L	9/32	
	ATSKNL420J			.1726									
ATSKN428J		1/4-28		.2371							ATSTD428L		
	ATSKNL428J			.1726									
ATSKN518J		5/16-18	7/16-14	.3049			.397	.447	7/16-14	.50	ATSTD518L	11/32	
	ATSKNL518J			.2321									
ATSKN524J		5/16-24		.3049							ATSTD524L		
	ATSKNL524J			.2321									
ATSKN616J		3/8-16	1/2-13	.4299			.453	.510	1/2-13	.56	ATSTD616L	13/32	3/16
	ATSKNL616J			.3366									
ATSKN624J		3/8-24		.4299							ATSTD624L		
	ATSKNL624J			.3366									
ATSKN714J		7/16-14	9/16-12	.5665			.516	.572	9/16-12	.62	ATSTD714L	15/32	
	ATSKNL714J			.4606									
ATSKN720J		7/16-20		.5665							ATSTD720L		
	ATSKNL720J			.4606									
ATSKN813J		1/2-13	5/8-11	.7175			.578	.635	5/8-11	.68	ATSTD813L	17/32	
	ATSKNL813J			.5906									
ATSKN820J		1/2-20		.7175							ATSTD820L		
	ATSKNL820J			.5906									



ATSKNH Series Threaded Inserts

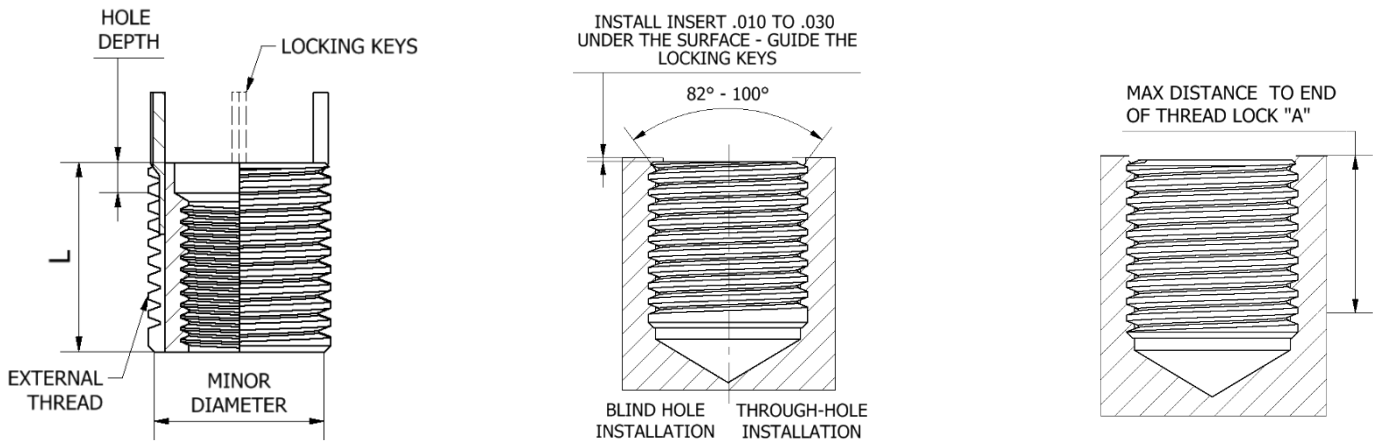

Code		Dimensions						Installation					Removal	
Standard	Locking	Ø Internal Thread 3B	Ø External Thread 2A	Anchor	L	C Hole Depth	A	Ø Pre-drilling Tapping	Ø Countersunk +,010/-,000	Filetto		Code Laying Tool	Tip	
										UNF-2B Misure	Min. Depth.		Ø	Depth
ATSKNH0832J		8-32	5/16-18	.1517		.40		.272	.323	5/16-18		ATSTHD0832L	7/32	1/8
	ATSKNHL0832J			.0945										
ATSKNH1024J		10-24	3/8-16	.1901	.31			.332	.385	3/8-16	.37	ATSTHD1024L	9/32	
	ATSKNHL1024J			.1156										
ATSKNH1032J		10-32	3/8-16	.1901								ATSTHD1032L		
	ATSKNHL1032J			.1156										
ATSKNH420J		1/4-20	7/16-14	.2842		.37		.397	.447	7/16-14	.43	ATSTHD420L	11/32	
	ATSKNHL420J			.1970										
ATSKNH428J		1/4-28	7/16-14	.2842		.70						ATSTHD428L		
	ATSKNHL428J			.1970										.33
ATSKNH518J		5/16-18	1/2-13	.3588	.43			.453	.510	1/2-13	.50	ATSTHD518L	13/32	3/16
	ATSKNHL518J			.2608										
ATSKNH524J		5/16-24	1/2-13	.3588								ATSTHD524L		
	ATSKNHL524J			.2608										
ATSKNH616J		3/8-16	9/16-12	.4975	.50			.516	.572	9/16-12	.56	ATSTHD616L	15/32	
	ATSKNHL616J			.3843										.41
ATSKNH624J		3/8-24	9/16-12	.4975								ATSTHD624L		
	ATSKNHL624J			.3843										.37

ATSKNH714J		7/16-14	5/8-11	.7172	.62	.45	.578	.635	5/8-11	.68	ATSTHD714L	17/32			
	ATSKNHL714J			.5831											
ATSKNH720J		7/16-20	5/8-11	.7172	.62	.42	.578	.635	5/8-11	.68	ATSTHD720L	17/32			
	ATSKNHL720J			.5831											
ATSKNH813J		1/2-13	11/16-11 NS	.8884	.68	.47	.641	.700	11/16-11 NS	.75	ATSTHD813L	19/32			
	ATSKNHL813J			.7368											
ATSKNH820J		1/2-20		11/16-11 NS	.8884	.68	.42	.641	.700	11/16-11 NS	.75	ATSTHD820L	19/32		
	ATSKNHL820J				.7368										
ATSKNH912J		9/16-12	13/16-16		1.2493	.81	.54	.766	.822	13/16-16 UN	.94	ATSTHD912L	23/32		
	ATSKNHL912J				1.0247										
ATSKNH918J		9/16-18		13/16-16	1.2493	.81	.48	.766	.822		13/16-16 UN	.94	ATSTHD918L	23/32	
	ATSKNHL918J				1.0247										
ATSKNH1011J		5/8-11	7/8-14		1.4866	.87	.57	.828	.885	7/8-14 UNF		1.00	ATSTHD1011L	25/32	
	ATSKNHL1011J				1.2415										
ATSKNH1018J		5/8-18		7/8-14	1.4866	.87	.49	.828	.885		7/8-14 UNF	1.00	ATSTHD1018L	25/32	
	ATSKNHL1018J				1.2415										
ATSKNH1210J		3/4-10	1-1/8-12		2.4901	1.12	.75	1.062	1.145	1-1/8-12 UNF		1.31	ATSTHD1210L	31/32	
	ATSKNHL1210J				2.4478	1.25						1.44			
ATSKNH1216J		3/4-16		1-1/8-12	2.4901	1.12	.68	1.062	1.145		1-1/8-12 UNF	1.31	ATSTHD1216L	31/32	
	ATSKNHL1216J				2.4478	1.25						1.44			
ATSKNH1409J		7/8-9	1-1/4-12		3.1370	1.25	.77	1.187	1.270	1-1/4-12 UNF		1.44	ATSTHD1409L	1-3/32	5/16
	ATSKNHL1409J				3.0775	1.37						1.56			
ATSKNH1414J		7/8-14		1-1/4-12	3.1370	1.25	.69	1.187	1.270		1-1/4-12 UNF	1.44	ATSTHD1414L	1-3/32	5/16
	ATSKNHL1414J				3.0775	1.37						1.56			
ATSKNH1608J		1-08	1-3/8-12		3.8381	1.37	.86	1.312	1.395	1-3/8-12 UNF		1.56	ATSTHD1608L	1-7/32	
	ATSKNHL1608J				3.7929	1.50						1.68			
ATSKNH1612J		1-12		1-3/8-12	3.8381	1.37	.78	1.312	1.395		1-3/8-12 UNF	1.56	ATSTHD1612L	1-7/32	
	ATSKNHL1612J				3.7929	1.50						1.68			





The company A.T.S. s.n.c. was founded in 1983 initially as technical assistance and support in the field of spot welding, then following to several customer request, the founder Lamberti Bruno, afterwards followed by his wife Lucia Manferdini and by his daughter Cinzia decide to expand the potential of the company acquiring the trading license for the marketing of welding system and related spare parts.

During the years, over 30, the company A.T.S s.r.l. has seen a great evolution and expansion of its business activities with the first and only target of the “customer satisfaction”.

Today A.T.S. s.r.l with the help of good collaborators who systematically attend training courses and updating stands in the foreground in the supply of equipment listed in the catalog defined standard and it has specialized in manufacturing components according to customer specifications and designs, and any other component at request regarding the field of spot welding, welding and fixing.

All the equipment sold or rental services are guaranteed by assistance of technical staff specialized that use instrumentation certified.

On the date July 22nd, 2002 the company A.T.S. s.r.l. gets with great satisfaction and pride the certification of the quality management system UNI EN ISO 9001:2000 conforming to the new standard UNI EN ISO 9001:2008 from July 01st,2009.

The main attention is focused on the customer, the ability to recognize their needs and expectations in order to be in line with market expectations trying to achieve the targets through continuous improvement.



CONTACT

ADDRESS:

A.T.S. s.r.l. 40023 Castel Guelfo (BOLOGNA) – Via del Mangano, 4/A

TELEPHONE:

+39 0542.67.04.27

FAX:

+39 0542.67.04.37

E-MAIL:

info@atslamberti.com

WEB SITE:

[http:// www.atslamberti.com](http://www.atslamberti.com)

VAT NUMBER:

00824841209 C.F. 04169740372

